

## Operating Instructions Basic Guide

### Wireless Presentation System For business use



# PressIT

Model No.	<b>TY-WPS1W</b> WPS Basic Set	<b>TY-WP2B1W</b> WPS Transmitter Set	<b>TY-WP2BC1W</b> WPS USB-C Transmitter Set
	<b>TY-WPSC1W</b> WPS USB-C Basic Set	<b>TY-WPB1W</b> WPS Transmitter	<b>TY-WPBC1W</b> WPS USB-C Transmitter

\* WPS is an abbreviation of "Wireless Presentation System".

Thank you for purchasing the Panasonic product.

- Please read these instructions before operating this product and retain them for future reference.
- **Be sure to read "Safety Precautions" (page 2 to 4) before use.**
- These Operating Instructions are shared by TY-WPS1W, TY-WPSC1W, TY-WP2B1W, TY-WPB1W, TY-WP2BC1W and TY-WPBC1W.

English

Safety Precautions	2
Accessories	5
Part Names	6
Connection	8
Basic Use	10
Fixing the Transmitter Connection	12
Transmitter Extension Method (Pairing)	13
Installing the Receiver	15
Notes on Using Wireless LAN	17
Request Regarding Security	19
Specifications	21

# Safety Precautions

## **WARNING:**

**Stop using the product immediately when an abnormality or malfunction occurs.**

**Remove the power plug in the case of an abnormality.**

- Smoke is emitted, or abnormal smell or sound occurs.
- Video or audio is not reproduced in some cases.
- Liquid such as water or a foreign object has entered inside the product.
- The product is deformed or damaged.

Using the product in such states may cause a fire or electric shock.

- Remove the power plug from the outlet and request repair to the dealer where you purchased the product.
- It is necessary to remove the power plug to completely turn off the power of this product.
- Do not repair the product by the customer since it is dangerous.
- Use an outlet located at a position where the hand can reach easily so that the power plug can be removed quickly.

**Do not insert foreign objects into the product.**

Do not insert or drop metals or flammable items into the inside the product from the vent hole, etc.

Smoke is emitted, or abnormal smell or sound occurs.

- Keep an eye on children in particular.

## **■ About AC adaptor**

**Do not use an AC adaptor or AC adaptor cable other than those supplied with this product.**

Using an AC adaptor or AC adaptor cable other than those supplied may cause an electric shock or fire due to short circuit or heat generation.

**Clean the power plug periodically to prevent dust from accumulating.**

Failure to do so may cause a fire or electric shock due to moisture.

- Remove the power plug and wipe it with dry cloth.

**Do not insert or remove the power plug with wet hand.**

Doing so may cause an electric shock.

**Do not use the outlet or wiring devices exceeding rated values or with currents other than 100 – 240 V AC.**

Using them exceeding rated values by connecting too many plugs in one outlet may cause a fire due to heat generation.

**Insert the power plug securely to the end.**

Insufficient insertion may cause a fire due to an electric shock or heat generation.

- Do not use the product with a damaged plug or loose outlet.

**Do not damage the AC adaptor and power plug.**

( by damaging, modifying, forcibly bending, twisting, pulling or bundling them, bringing them close to heat appliances, placing heavy items on them, etc. )

Doing so may cause a fire or electric shock due to short circuit or disconnection.

- Request the dealer for repair of the AC adaptor or power plug.

**Use the product 15 cm or more away from a location where a cardiac pacemaker is embedded.**

Radio waves may affect the operation of the pacemaker.

**Do not use the product in an airplane.**

The operational safety may be impaired.

**Do not use the product near an automatic door, fire alarm or other automatic control devices.**

Radio waves from this product may affect automatic control devices, which may cause an operational error, resulting in an accident.

**Do not use the product in hospital or a location with medical equipment.**

Radio waves from this product may affect medical equipment, which may cause an operational error, resulting in an accident.

**Do not use the product while touching it for a long time.**

Touching the hot parts of the product and AC adaptor for a long time may cause a low-temperature burn\*.

- \* Persons with poor bloodstream (due to vascular impairment, poor blood circulation, diabetes or strong compression) or poor skin sensitivity (elderly persons) tend to get a low-temperature burn.

**Do not touch the product and AC adaptor if it begins to thunder.**

Doing so may cause an electric shock.

**Do not wet the product.**

Doing so may cause a fire or electric shock.

**Do not place the product on unstable locations.**

Placing the product on a shaky table or an inclined location may cause an injury due to falling over or dropping.

**Do not remove or modify the back cover (cabinet).**

**Keep the screws supplied with the receiver out of reach of infants.**

The screws may be accidentally swallowed.

- In the event this occurs, consult a doctor immediately.

**For installation, please ask a qualified technician or a dealer.**

If installation is not carried out and secured correctly, it can cause falling accidents.

**Do not touch the bottom surface of the transmitter during use.**

The bottom surface of the transmitter may be hot during and after use for a while, resulting in a burn injury.

Also, do not place it on an object sensitive to heat. Doing so may cause deformation or discoloration.

## **CAUTION:**

**Do not block the vent hole of this product.**

**Do not push the product into a narrow and poorly ventilated space.**

Doing so may cause heat to accumulate inside, resulting in a fire or malfunction.

**Do not place a heavy item on the product.**

Doing so may cause a fire or malfunction.

**Do not place the product at a high-temperature location, humid or dusty location, or location subject to oil smoke or steam (such as a cooking table and humidifier).**

Doing so may cause a fire or electric shock.

**When removing the connection cables, be sure to hold the connector and pull it.**

Pulling the cord may damage the cord, resulting in a fire due to an electric shock or short circuit.

**When transferring the product, remove the connection cables of equipment beforehand.**

Failure to do so may damage the cord or product, resulting in a fire or electric shock.

**When not using the product for a prolonged period, remove the power plug from the outlet.**

Dust may accumulate in the power plug, resulting in a fire or electric shock.

**Do not pull or hang the connection cables.**

Doing so may cause the product to fall over or drop, resulting in an injury.

- Keep an eye on children in particular.

## **■ Maintenance**

**For maintenance, remove the power plug from the outlet for safety.**

Failure to do so may cause an electric shock.

# Accessories

Check that you have the accessories and items shown.

## WPS Basic Set TY-WPS1W

WPS Receiver (TY-WPR1W)..... 1	WPS Transmitter (TY-WPB1W)..... 2	Transmitter case (TY-WPC1) ..... 1
-----------------------------------	--------------------------------------	---------------------------------------

AC adaptor (DPVF3699ZA/X1)... 1 (including 4 conversion plugs)	AC adaptor cable (DPVF3515ZA/X1)... 1	HDMI cable (DPVF3512ZA/X1)... 1
---	--	------------------------------------

USB extension cable (DPVF3513ZA/X1)... 2	Receiver mounting bracket (see page 15) ..... 1
---	---

## WPS USB-C Basic Set TY-WPSC1W

WPS Receiver (TY-WPR1W)..... 1	WPS USB-C Transmitter (TY-WPBC1W)..... 2	Transmitter case (TY-WPC1) ..... 1
-----------------------------------	---	---------------------------------------

AC adaptor (DPVF3699ZA/X1)... 1 (including 4 conversion plugs)	AC adaptor cable (DPVF3515ZA/X1)... 1	HDMI cable (DPVF3512ZA/X1)... 1
---	--	------------------------------------

Conversion adaptor for pairing (DPVF3516ZA/X1)... 1	Receiver mounting bracket (see page 15) ..... 1
---	---

## WPS Transmitter Set TY-WP2B1W

WPS Transmitter (TY-WPB1W)..... 2	Transmitter case (TY-WPC1) ..... 1	USB extension cable (DPVF3513ZA/X1)... 2
--------------------------------------	---------------------------------------	---

## WPS Transmitter TY-WPB1W

WPS Transmitter (TY-WPB1W)..... 1	USB extension cable (DPVF3513ZA/X1)... 1
--------------------------------------	---

## WPS USB-C Transmitter Set TY-WP2BC1W

WPS USB-C Transmitter (TY-WPBC1W) ..... 2	Transmitter case (TY-WPC1) ..... 1	Conversion adaptor for pairing (DPVF3516ZA/X1)... 1
---	---------------------------------------	---

## WPS USB-C Transmitter TY-WPBC1W

WPS USB-C Transmitter (TY-WPBC1W) ..... 1	Conversion adaptor for pairing (DPVF3516ZA/X1)... 1
---	---

### Attention

- Store small parts in an appropriate manner, and keep them away from young children.
- The part numbers of accessories are subject to change without notice.  
(The actual part number may differ from the ones shown above.)
- In case you lost accessories, please purchase them from your dealer. (Available from the customer service)
- Dispose the packaging materials appropriately after taking out the items.

# Part Names

## Receiver (TY-WPR1W)

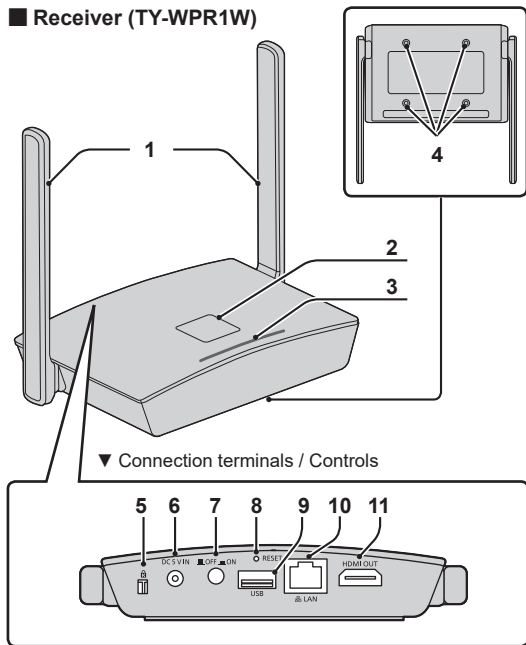

### 1 Antenna

### 2 FUNCTION button / LED

Used to save a pairing file to the USB memory.

### 3 Indicator

Displays the power supply status, and connection statuses of LAN and USB.

### 4 Screw holes for mounting bracket (page 15)

Used to attach the receiver to the mounting bracket.

### ▼ Connection terminals / Controls

### 5 Security Slot

This security slot is compatible with a Noble Wedge slot.

### 6 Power input terminal

### 7 Power button

Turns ON/OFF the power of the receiver.

### 8 Reset button

Restores the product to the factory default state.

### 9 USB terminal (Type-A)

Connects the transmitter or USB memory when pairing devices.

### 10 LAN terminal (RJ45)

Connects to the network to change the settings of the product.

### 11 HDMI output terminal

Connects an imaging device equipped with HDMI input.

## ■ Transmitter (TY-WPB1W)

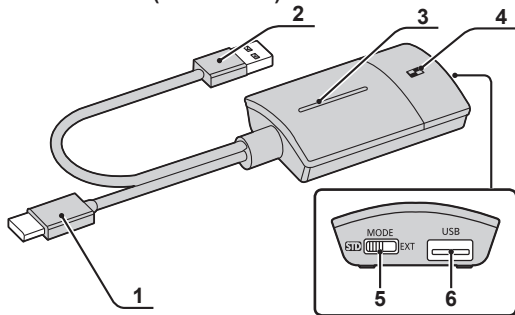

## ■ USB-C transmitter (TY-WPBC1W)

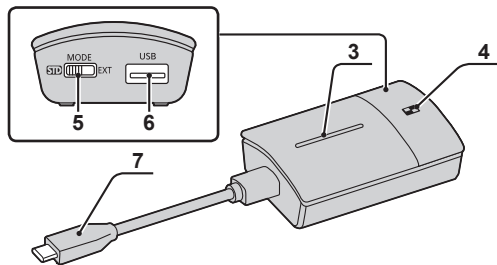

### 1 HDMI input terminal

Connect to an imaging device equipped with HDMI output.

### 2 USB terminal (Type-A)

Connect to a USB power supply device.

### 3 Main button / LED

Switches between on and off of image display.

### 4 Sub button / LED

Switches to the multi-screen mode.

### 5 Mode switch

It is used when pairing.

### 6 USB terminal (Type-A)

Connects a USB memory when pairing with the receiver.

### 7 USB terminal (Type-C)

Connect to an imaging device with USB Type-C output.

## ■ Transmitter case

2 transmitters and the USB extension cable can be stored.

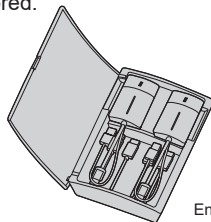

# Connection

Before connection, carefully read the operation manual of the device to be connected to this system.  
Turn off the power of each device before connecting cables.

## Connecting the receiver

- 1 Connect the AC adaptor and AC adaptor cable to the receiver for power supply.**
- ▶ Use an AC adaptor conversion plug that fits the shape of outlet.

<How to remove>

- ① Press the button
- ② Remove the plug

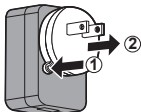

### Note

- Do not remove the AC adaptor conversion plug while it is connected to the outlet.

- 2 Connect a display device such as a display and projector to the receiver with HDMI cable.**

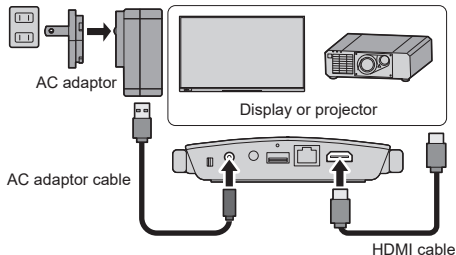

### Note

- For power supply to the receiver, use the supplied AC adaptor or a USB power supply device with 5 V/2 A.



- 3 Press the power button of the receiver. When a standby screen is displayed on the display device, the receiver has completed preparation.**

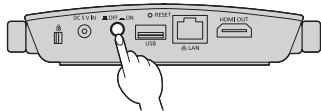

Standby screen

## Connecting the transmitter

- 1 Connect the USB terminal and HDMI input terminal of the transmitter to the image output device.**
- For power supply to the transmitter, 5 V/0.9 A power supply is necessary.

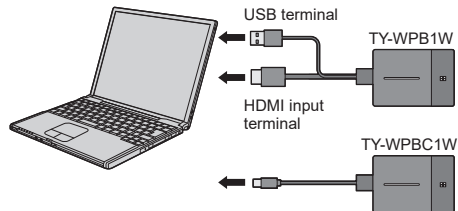

For the USB-C transmitter, connect the USB terminal (Type-C) to the image output device.

- 2 Main LED changes from red blinking (connecting) to white illumination (standby).**

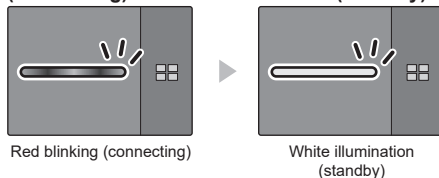

# Basic Use

## Single connection

This section describes how to display an image using one transmitter.

- 1 Press the main button of the transmitter while the standby screen is displayed.**

The image is displayed.

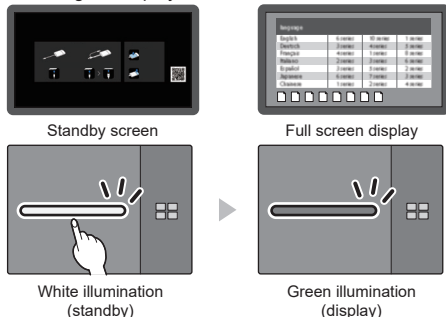

- ▶ Pressing the main button again changes the main LED to white and returns to standby state.**

(The screen returns to the standby screen as well.)

- When using multiple transmitters, the image is switched to the image of the transmitter of which the main button is pressed.

## Multi connection

This section describes how to display images simultaneously using multiple transmitters. Images of up to 4 transmitters can be displayed simultaneously.

- 1 Press and hold the sub button of the transmitter for 1 seconds or more during full screen display.**

The sub LED changes to green illumination, and the multi-screen mode is enabled.

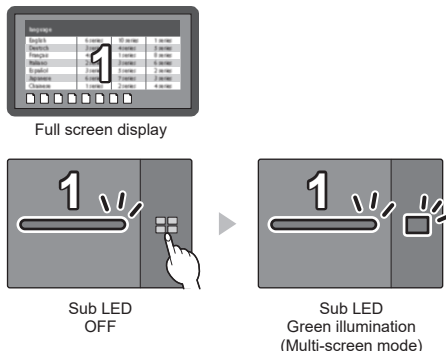

## 2 Press the main button of the transmitter of which the image is to be added.

The image is added.

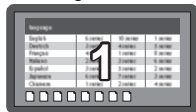

Full screen display

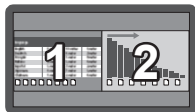

Multi-screen display

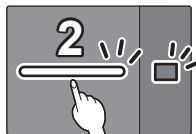

White illumination (standby)  
Sub LED Green illumination

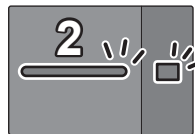

Green illumination  
Sub LED Green illumination

### ▶ Multi-screen mode cancellation

Press and hold the sub button of the transmitter for 1 seconds or more.

- The sub LED changes from green illumination to OFF state, and the multi-screen mode is canceled.

## Details of usage

For details of usage, read "Operating Instructions - Functional Manual".

Download the "Operating Instructions - Functional Manual" from the following URL.

<https://panasonic.net/cns/prodisplays/wps2/>

# Fixing the Transmitter Connection

While multiple transmitters are paired and used, you can connect only one transmitter to the receiver and disable switching to another transmitter.

This setting prevents accidental transmitter-switching operation.

## Setting the fixed mode

**Press and hold the main button of the transmitter for 1 seconds or more while an image of one transmitter is displayed.**

The main LED changes from green illumination to blue illumination, and the fixed mode is enabled.

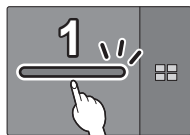
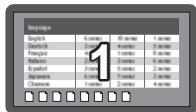
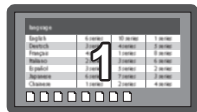

Green illumination

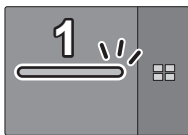

Blue illumination (fixed mode)

Other transmitters

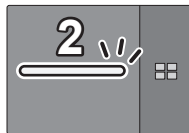

White illumination  
(standby)

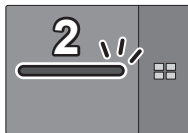

Red illumination  
(operation disabled)

## Canceling the fixed mode

**Press and hold the main button of the transmitter for 1 seconds or more.**

The main LED changes from blue illumination to green illumination, and the fixed mode is canceled.

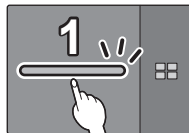

Blue illumination  
(fixed mode)

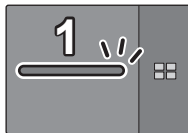

Green illumination  
(fixed mode canceled)

# Transmitter Extension Method (Pairing)

Pairing settings have been made for transmitter and receiver of TY-WPS1W Basic Set / TY-WPSC1W Basic Set.

## Pairing by connecting the receiver and transmitter

- 1 Slide the mode switch to the STD side.

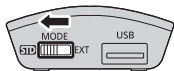

- 2 Connect the USB terminal of the transmitter to the USB terminal of the receiver.

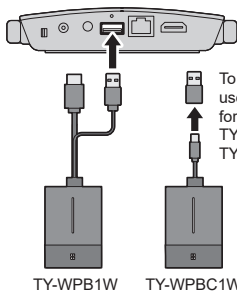

Wait for a while until the LED of the receiver blinks in white. Then, pairing starts automatically. "Pairing..." (pairing in progress) is displayed on the standby screen.

- 3 Pairing is complete.

"Pairing OK" is displayed and the LED of the receiver lights up in white.



- 4 Remove the USB cable of the transmitter from the receiver.

## Pairing by saving a file to the USB memory

### Supported device

- Commercially available USB memory devices are supported. (Those with security functions are not supported.)
- USB memory devices other than those formatted in FAT16 or FAT32 cannot be used.
- Up to 32 GB of USB memory in size are supported.
- Only single partition configuration is supported.

### 1 Connect the USB memory to the USB terminal of the receiver.

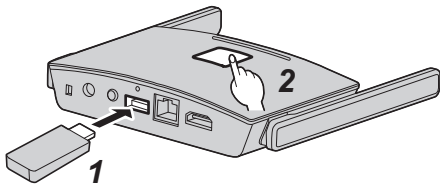

### 2 Press the FUNCTION button.

The LED lights up in white and the pairing file is saved to the USB memory.

### 3 Remove the USB memory.

### 4 Slide the mode switch to the EXT side.

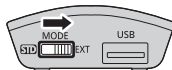

### 5 Supply power to the transmitter.

TY-WPB1W



TY-WPBC1W



5 V/0.9 A  
Power supply

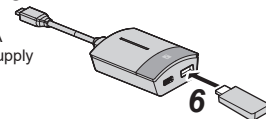

### 6 Connect the USB memory to the USB terminal of the transmitter.

### 7 Pairing is complete.

The main LED of the transmitter lights up in white.

### 8 Remove the USB memory from the transmitter.

# Installing the Receiver

## Components for receiver mounting bracket

Check the following parts are included.

Base bracket (A-1) .....1  
(DPVF3503ZA/X1)

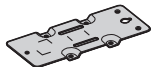

Sheet A (B-1) .....1  
(DPVF3507ZA/X1)  
(30 × 12 mm)



Connecting bracket A (A-2) ..1  
(DPVF3505ZA/X1)  
Used to install on the display.



Sheet B (B-2) .....3  
(DPVF3508ZA/X1)  
(24 × 20 mm)



Connecting bracket B (A-3) ....1  
(DPVF3504ZA/X1)  
Used to install on the display.



Knurled screw (C-1) .....2  
(DPVF3509ZA/X1)  
(M4 × 5)



Connecting bracket C (A-4) ....1  
(DPVF3506ZA/X1)  
Used to install on the projector.



Screw (C-2) .....6  
(DPVF3510ZA/X1)  
(M4 × 5)



Screw (C-3) .....2  
(DPVF3511ZA/X1)  
(M3 × 8)



## Installing on the ceiling or wall

**1** Place the base bracket (A-1) aligning it with the 4 screw holes on the bottom surface of the receiver.

**2** Fix the base bracket (A-1) with 4 screws (C-2).

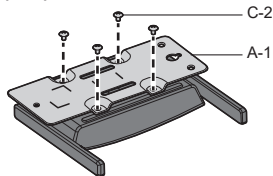

The base bracket can be mounted in either vertical or horizontal direction.

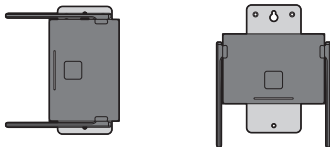

### 3 Fix the receiver to the ceiling or wall with 2 screws.

Use screws (commercially available) of the appropriate type and length according to the ceiling or wall to be installed. (Recommended size: M4)

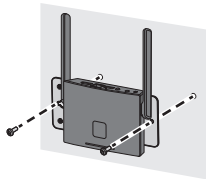

#### Other installation method

The receiver can be installed on the display or projector.

##### ● Installing on the display

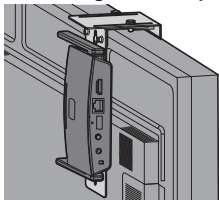

##### ● Installing on the projector

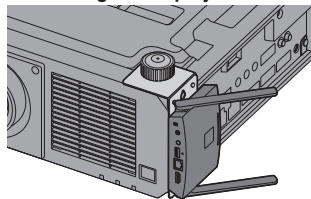

For details of installation method, read “Operating Instructions - Functional Manual”.

Download the “Operating Instructions - Functional Manual” from the following URL.

<https://panasonic.net/cns/prodisplays/wps2/>



# Notes on Using Wireless LAN

Wireless LAN uses radio waves in the 5 GHz bands.  
Be sure to read and fully understand the following items before use.

## **Use this product indoors.**

- Using the 5 GHz-band wireless device outdoors is prohibited by the Radio Act.

## **If at all possible, avoid the use of cellular phones, TV sets or radios near the product.**

- Cellular phones, TV sets, radios and similar devices use different radio bands from the product, so there is no effect on wireless communication or the transmission and reception of these devices. However, radio waves from the product may produce audio or video noise.

## **Wireless communication radio waves cannot penetrate steel reinforcements, metal, concrete, etc.**

- Communication is possible through walls and floors made from materials such as wood and glass (except glass containing wire mesh), but not through walls and floors made from steel reinforcements, metal, concrete, etc.

## **The product may not work properly due to strong radio wave from the broadcast station or the radio.**

- If there is any facility or equipment, which outputs strong radio wave, near the installation location, set up the product at a location sufficiently far from the source of the radio wave.

## **Using the product outside the country**

- It is forbidden to take the product outside the country or region where you purchased it, so use it only in the said country or region. Also, note that depending on countries or regions there are restrictions on the channels and frequencies at which you can use the wireless LAN.

### Declaration of Conformity (DoC)

"Hereby, Panasonic Corporation declares that this product is in compliance with the essential requirements and other relevant provisions of the Directive 2014/53/EU."

If you want to get a copy of the original DoC of this product, please visit the following website:

<http://www.ptc.panasonic.de>

Authorized Representative:

Panasonic Testing Centre

Panasonic Service Europe, a division of Panasonic Marketing Europe GmbH

Winsbergring 15, 22525 Hamburg, Germany

Indoor use restrictions are to be followed for the following countries if using 5 GHz frequency band.

Austria, Belgium, Bulgaria, Croatia, Cyprus, Czech Republic, Denmark, Estonia, Finland, France, Germany, Greece, Hungary, Iceland, Ireland, Italy, Latvia, Liechtenstein, Lithuania, Luxembourg, Malta, Netherlands, Norway, Poland, Portugal, Romania, Slovakia, Slovenia, Spain, Sweden, Switzerland, Turkey, United Kingdom

#### **WLAN: Maximum Power**

23 dBm (5.180 GHz - 5.240 GHz)

Directive: 2014/53/EU

# Request Regarding Security

**When using this product, take safety measures against the following incidents.**

- Personal information being leaked via this product
- Unauthorized operation of this product by a malicious third party
- Interfering or stopping of this product by a malicious third party

**Take sufficient security measures.**

## **Precautions on security when using wireless LAN products**

- The advantage of a wireless LAN is that information can be exchanged between a PC or other such equipment and an access point using radio waves as long as you are within range for radio transmissions. On the other hand, because the radio waves can travel through obstacles (such as walls) and are available everywhere within a given range, problems of the type listed below may occur if security-related settings are not made.
  - A malicious third-party may intentionally intercept and monitor transmitted data including the content of e-mail and personal information such as your ID, password, and/or credit card numbers.

- A malicious third-party may access your personal or corporate network without authorization and engage in the following types of behaviour.

Retrieve personal and/or secret information (information leak)

Spread false information by impersonating a particular person (spoofing)

Overwrite intercepted communications and issue false data (tampering)

Spread harmful software such as a computer virus and crash your data and/or system (system crash)

- Since most wireless LAN adaptors or access points are equipped with security features to take care of these problems, you can reduce the possibility of these problems occurring when using this product by making the appropriate security settings for the wireless LAN device.
- Some wireless LAN devices may not be set for security immediately after purchase. To decrease the possibility of occurrence of security problems, before using any wireless LAN devices, be absolutely sure to make all security-related settings according to the instructions given in the operation manuals supplied with them.

Depending on the specifications of the wireless LAN, a malicious third-party may be able to break security settings by special means.

Please contact Panasonic if you need help taking care of security settings or other such.

If you cannot perform security settings for your wireless LAN by yourself, please contact the Panasonic Support Center.

- Panasonic asks customers to thoroughly understand the risk of using this product without making security settings, and recommends that the customer make security settings at their own discretion and responsibility.

# Specifications

## Receiver

Model No.	TY-WPR1W
Product name	WPS Receiver
Video output	HDMI × 1 (HDCP1.4)
Output resolution	1920 x 1080/60p, 3840 x 2160/30p (max.)
Number of simultaneous connections	32
Wireless communication standard	IEEE802.11a/n/ac Bluetooth (GFSK, π/4-DQPSK, 8DPSK)
Data rate wireless	867 Mbps (max.)
Frequency band	5 GHz (5.150 GHz to 5.250 GHz)
Security	WPA/WPA2
Reachable distance	Up to 30 m (Locations with good visibility and radio wave conditions)
<b>FUNCTION LED</b>	
White blinking	Pairing in progress
White illumination	Pairing complete
LAN terminal	RJ45 × 1 10BASE-T/100BASE-TX/ 1000BASE-T supported
USB terminal	USB connector × 1, Type-A
Power supply	DC 5 V/2 A
Dimensions (W × H × D)	120 mm × 26 mm × 81 mm / 4.71" × 1.03" × 3.19" (excluding antennas)
Mass	Approx. 181 g / 0.4 lbs
Operating condition	Temperature: 0 °C to 35 °C (32 °F to 95 °F) Humidity: 20 % to 80 % (no condensation)
Storage condition	Temperature: -20 °C to 60 °C (-4 °F to 140 °F) Humidity: 20 % to 80 % (no condensation)

## Transmitter

Model No.	TY-WPB1W	TY-WPBC1W
Product name	WPS Transmitter	WPS USB-C Transmitter
Video input	HDMI × 1 (HDCP1.4)	USB Type-C × 1 (HDCP1.4, DisplayPort Alt Mode)
Input resolution	1920 x 1080/60p (max.)	
Wireless communication standard	IEEE802.11a/n/ac	
Data rate wireless	433 Mbps (max.)	
Frequency band	5 GHz (5.150 GHz to 5.250 GHz)	
Security	WPA/WPA2	
Reachable distance	Up to 30 m (Locations with good visibility and radio wave conditions)	
<b>Main LED</b>		
White blinking	Pairing in progress	
White illumination	Standby or pairing complete	
Red blinking	Connecting	
Red illumination	Operation disabled	
Green illumination	Image being displayed	
Blue illumination	Fixed mode	
<b>Sub LED</b>		
Green illumination	Multi-screen mode	
USB terminal	USB connector × 1, Type-A	
Power supply	DC 5 V/0.9 A	
Dimensions (W × H × D)	51 mm × 21 mm × 73 mm / 2.00" × 0.80" × 2.86" (excluding cables)	51 mm × 26 mm × 73 mm / 2.00" × 1.00" × 2.86" (excluding cables)
	51 mm × 21 mm × 283 mm / 2.00" × 0.80" × 11.12" (including cables)	51 mm × 26 mm × 178 mm / 2.00" × 1.00" × 6.98" (including cables)
Mass	Approx. 110 g / 0.3 lbs	Approx. 110 g / 0.3 lbs
Operating condition	Temperature: 0 °C to 35 °C (32 °F to 95 °F) Humidity: 20 % to 80 % (no condensation)	
Storage condition	Temperature: -20 °C to 60 °C (-4 °F to 140 °F) Humidity: 20 % to 80 % (no condensation)	

## Software License

This product incorporates the following software:

- (1) the software developed independently by or for Panasonic Corporation,
- (2) the software owned by third party and licensed to Panasonic Corporation,
- (3) the software licensed under the GNU General Public License, Version 2.0 (GPL V2.0),
- (4) the software licensed under the GNU LIBRARY General Public License, Version 2.0 (LGPL V2.0),
- (5) the software licensed under the GNU LESSER General Public License, Version 2.1 (LGPL V2.1), and/or
- (6) open source software other than the software licensed under the GPL V2.0, LGPL V2.0 and/or LGPL V2.1.

The software categorized as (3) - (6) are distributed in the hope that it will be useful, but WITHOUT ANY WARRANTY, without even the implied warranty of MERCHANTABILITY or FITNESS FOR A PARTICULAR PURPOSE. For details, see the license conditions displayed by selecting [Software licenses], following the specified operation from the Web setting screen of this product.

At least three (3) years from delivery of this product, Panasonic will give to any third party who contacts us at the contact information provided below, for a charge no more than our cost of physically performing source code distribution, a complete machine-readable copy of the corresponding source code covered under GPL V2.0, LGPL V2.0, LGPL V2.1 or the other licenses with the obligation to do so, as well as the respective copyright notice thereof.

Contact Information:

[oss-cd-request@gg.jp.panasonic.com](mailto:oss-cd-request@gg.jp.panasonic.com)

### Trademark Credits

- HDMI, High-Definition Multimedia Interface and the HDMI Logo are trademarks or registered trademarks of HDMI Licensing Administrator, Inc. in the United States and other countries.
- USB Type-C and USB-C are trademarks or registered trademarks of USB Implementers Forum.
- PressIT is a trademark of Panasonic Corporation.

Even if no special notation has been made of company or product trademarks, these trademarks have been fully respected.



### Information on Disposal in other Countries outside the European Union

These symbols are only valid in the European Union.

If you wish to discard these items, please contact your local authorities or dealer and ask for the correct method of disposal.

## Customer's Record

The model number and serial number of this product may be found on its rear panel. You should note this serial number in the space provided below and retain this book, plus your purchase receipt, as a permanent record of your purchase to aid in identification in the event of theft or loss, and for Warranty Service purposes.

**Model Number**

**Serial Number**

---

**Panasonic Corporation**

English

Web Site: <https://panasonic.net/cns/prodisplays/>